

-20°C - -40°C Low Temperature Freezer

Applications

Medical, Reagents, Biological, Vaccine, Suitable for Medical, Electronics, Chemicals, R&D, University Research, Food Process.

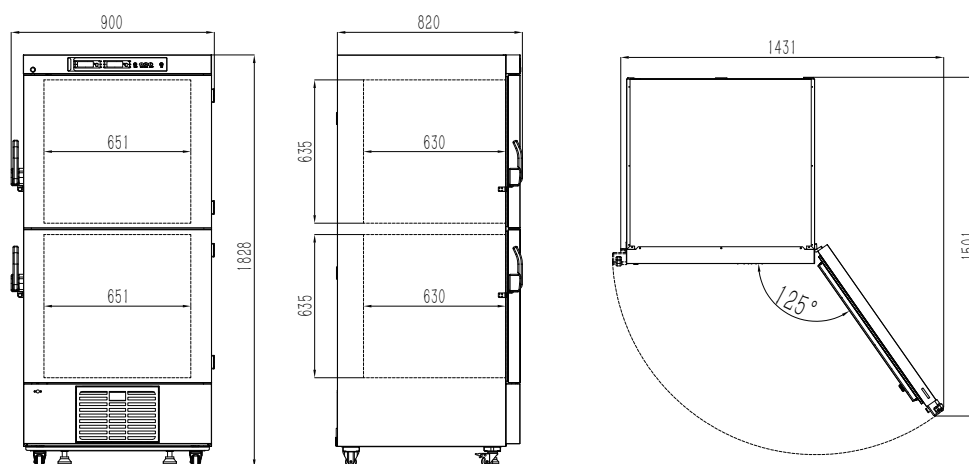

Outline & Door Opening Dimension

Cooling System

- Temperature Range: : -20°C - -40°C .
- Microprocessing controller, LED display, temperature adjustment and display accuracy is 0.1°C .
- The outer door adopts unique sealing structure, which can ensure the freezer with good sealing and heat preservation performance.
- The upper and lower storage spaces with two completely independent cooling system, temperature control and display.
- Compressors are efficient and reliable.

Safety

- Build-in back-up battery to display temperature and alarm information for up to 8 hours, if AC power is failure.
- With high/low temperature alarm, sensor failure alarm, power failure alarm, door ajar alarm. Two ways of alarm: visual and audible.
- The handle has a padlock hole that can be used to provide an extra protection of security for storage.
- Button on the control panel can be locked to avoid setting parameters being changed due to misoperation.
- With compressor delay start protection function when power off restart.

- Efficient and environmentally friendly HC refrigerant is used.
- Build-in mechanical lock to ensure the safety of storage.
- Safe mode will be ran automatically in case of sensor failure to ensure the temperature for storage.

Easy Operation

- Door frame can be heated to avoid condensation.
- Standard testing ports for easy access to external test tools.
- Buzzing alarm can also be set to mute if required.
- Standard drawer, easy to storage and management.
- The bottom is provided with leveling feet to ensure the levelness of the freezer body during installation.
- In case of failure, the control screen displays real-time temperature and corresponding alarm code, which is convenient for trouble shooting.
- The specially designed handle can balance the pressure difference between inside and outside the chamber while pulling, to ensure outer door can be opened easily and smoothly.

Technical Specifications

Model	BDW-40L530D
Temperature Range [°C]	-20 - -40
Effective Capacity [Liters]	265 × 2
Insulation Thickness [mm]	95
Exterior dimensions W x D x H [mm]	900 x 820 x 1828
Up chamber Interior dimensions W1 x D1 x H1 [mm]	651 x 630 x 635
Down chamber Interior dimensions W1 x D1 x H1 [mm]	651 x 630 x 635
Door opening W2 x H2 [mm]	1431 x 1501
Exterior Finishing	White Plastic Coated Galvanised Steel
Interior Finishing	
Levels	3 × 2
Drawers	3 × 3 × 2
Mechanical Lock	Yes
Battery	Yes
Temperature Sensor in Chamber	Yes
Gasket Heating	Yes
Controller Type	Digital Screen
Refrigerant	HC
Voltage/Frequency [V / Hz]	AC220 / 50
Rated Power [W]	340
Net Weight [kg]	160
Power Failure Alarm	Yes
Temperature Sensor Failure Alarm	Yes
High/Low Temperature Alarm	Yes
Door Ajar Alarm	Yes
Temperature Resolution [°C]	0.1
Temperature Uniformity [°C]	≤6
Pull Down Time [h]	≤4.1